

VASE: JO

Design by
Eric Jourdan

Description

Vases in moulded ceramic finished in gloss blue enamel on the interior and front, and sanded matt white enamel on the rear (rounded).

or
Vases in moulded plain-coloured enamelled ceramic. Gloss finish on the front face and sanded matt finish on the reverse (rounded).

These unusual vases come straight from the imagination of Eric Jourdan, demonstrating his mastery of proportion and design.

Technical Specifications

More info at
www.ligne-roset.com

© Ligne Roset 2021



VASE SHORT NECK/BLUE

DIMENSIONS

H 390 mm - W 160 mm - D 130 mm -

Other sizes



vase short neck/blue

DIMENSIONS

H 390 - mm
W 160 - mm
D 130 - mm



vase short neck pale pink

DIMENSIONS

H 390 - mm
W 160 - mm
D 130 - mm



vase short neck pale green

DIMENSIONS

H 390 - mm
W 160 - mm
D 130 - mm



vase short neck beige

DIMENSIONS

H 390 - mm
W 160 - mm
D 130 - mm

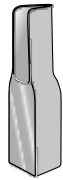

vase long neck pale green

DIMENSIONS

H 390 - mm

W 120 - mm

D 100 - mm